

MATERIALS AND FINISHES

BODY: ZINC
 PLATED: NICKEL (100 MICROINCHES MIN)

CENTER CONTACT: PHOSPOR BRONZE
 PLATED: GOLD (30 MICROINCHES MIN)

OUTER CONTACT: BeCu
 PLATED: NICKEL (100 MICROINCHES MIN)

CRIMP TUBE: BRASS
 PLATED: NICKEL (100 MICROINCHES MIN)

OUTER CASING: NYLON
 KEYING: SEE TABLE
 COLOR: SEE TABLE

INSULATOR: TEFLON

CABLE: RG174, 187, 188, & 316

RETENTION SPECIFICATION:

THE SHROUD WILL WITHSTAND A
 LONGITUDINAL FORCE OF 24.73 POUNDS (110N)

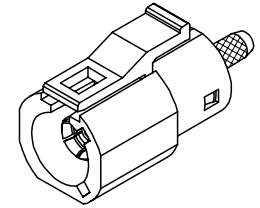
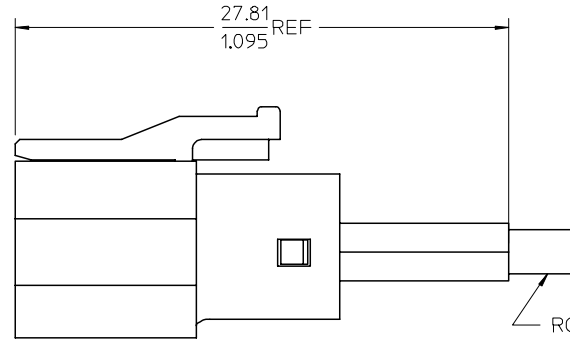

RG174, 187, 188, AND 316

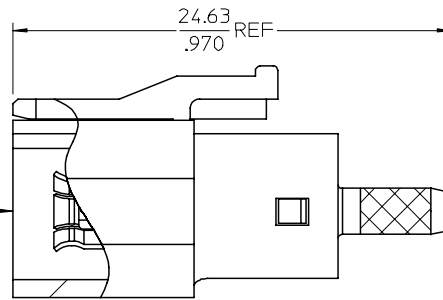

FAKRA
 CONNECTOR
 KEYING
 CODE D SHOWN

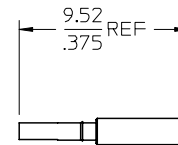

CONTACT

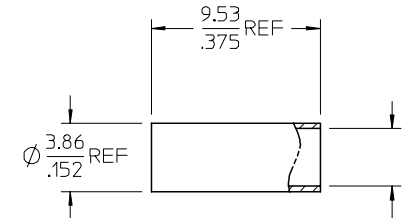

CRIMP BODY

3.25 REF
 .128

PART # SEE SHEET 2

AS-89678-680	ASSEMBLY INSTRUCTION
MIL-STD-384A, FIG 311-2	INTERFACE SPECIFICATION
SPECIFICATION	DESCRIPTION

CHG: REDREW TO SHOW PROPER ORIENTATION ON BODY EC NO: URF2006-0549 DRWN: IFLAHERY 2006/06/08 CHKD: SHAH 2006/06/08 APPR: JIMENER 2006/06/08 REVISION DESCRIPTION	QUALITY SYMBOLS	GENERAL TOLERANCES (UNLESS SPECIFIED)	DIMENSION STYLE	SCALE	DESIGN UNITS	THIRD ANGLE PROJECTION	
	=0 =0	mm INCH 4 PLACES ± .0005 ± .0005 3 PLACES ± .0005 ± .0005 2 PLACES ± .0005 ± .0005 1 PLACE ± .0005 ± .0005 ANGULAR ± 2°	MM/IN	DRAWN BY DATE SSS 2001/03/07 CHECKED BY DATE TEF 2001/03/07 APPROVED BY DATE GMH 2001/03/07	METRIC	SMB PLUG, FAKRA RG174,187,188,316 CABLE SMB-JC	Molex MOLEX INCORPORATED
	DRAFT WHERE APPLICABLE MUST REMAIN WITHIN DIMENSIONS	SEE SHT 2	MATERIAL NO.	DOCUMENT NO.	SHEET NO.	THIS DRAWING CONTAINS INFORMATION THAT IS PROPRIETARY TO MOLEX INCORPORATED AND SHOULD NOT BE USED WITHOUT WRITTEN PERMISSION	
						1 OF 2	

13 12 11 10 9 8 7 6 5 4 3 2 1

J
I
H
G
F
E
D
C
B
A

J
I
H
G
F
E
D
C
B
A

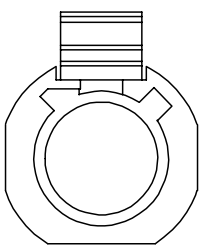

CODE - A

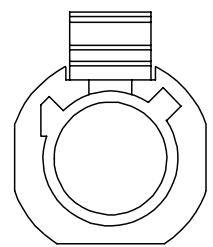

CODE - B

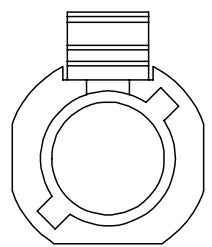

CODE - C

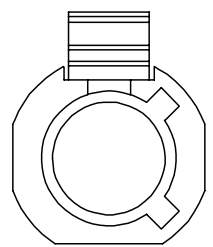

CODE - D

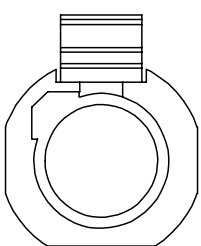

CODE - E

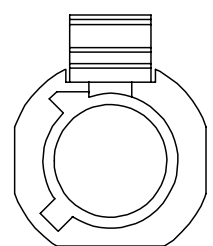

CODE - F

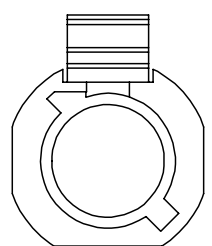

CODE - G

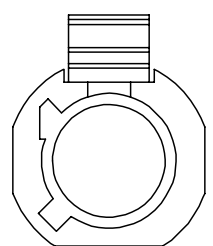

CODE - H

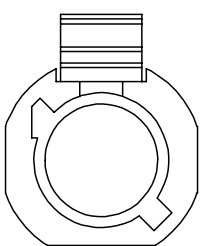

CODE - I

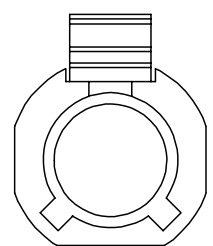

CODE - K

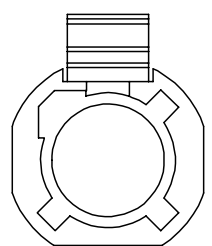

CODE - Z

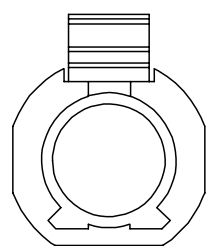

CODE - L

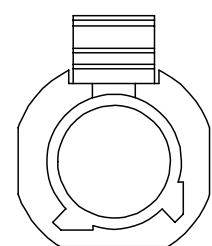

CODE - M

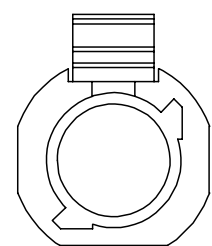

CODE - N

N	PASTEL GREEN	73415-2923
M	PASTEL ORANGE	73415-2922
L	CARMINE RED	73415-2921
Z	WATER BLUE	73415-2920
K	CURRY YELLOW	73415-2919
I	BEIGE	73415-2918
H	VIOLET	73415-2917
G	GRAY	73415-2916
F	BROWN	73415-2915
E	GREEN	73415-2914
D	BORDEAUXVIOLET	73415-2913
C	BLUE	73415-2912
B	CREAM WHITE	73415-2911
A	BLACK	73415-2910
KEYING CODE	COLOR	PART NO.

SEE SHEET 1
 FCC NO. URF2006-0549
 DRAWN: FLAHERTY 2006/06/08
 CHKD: SHAH 2006/06/08
 APPR: JIMENER 2006/06/08

QUALITY SYMBOLS
 ▽=0
 ▽=0

GENERAL TOLERANCES (UNLESS SPECIFIED)

	mm	INCH
4 PLACES	± .000	± .000
3 PLACES	± .001	± .001
2 PLACES	± .002	± .002
1 PLACE	± .003	± .003

ANGULAR ± 2 °

DRAFT WHERE APPLICABLE MUST REMAIN WITHIN DIMENSIONS

DIMENSION STYLE
 MM/IN

DRAWN BY DATE
 SSS 2001/03/07

CHECKED BY DATE
 TEF 2001/03/07

APPROVED BY DATE
 GMH 2001/03/07

MATERIAL NO.
 SEE TABLE

SCALE
 DESIGN UNITS METRIC

THIRD ANGLE PROJECTION

SMB PLUG, FAKRA
 RG174,187,188,316 CABLE
 SMB-JC

molex MOLEX INCORPORATED

DOCUMENT NO. SD-73415-291

SHEET NO. 2 OF 2

THIS DRAWING CONTAINS INFORMATION THAT IS PROPRIETARY TO MOLEX INCORPORATED AND SHOULD NOT BE USED WITHOUT WRITTEN PERMISSION

12 11 10 9 8 7 6 5 4 3 2 1